

# Venue Inventory and Equipment



## Inventory

- Auditorium

- 40' x 20' stage
  - Grand piano
  - 60" round tables
  - Stackable chairs
  - Multiple cable types for connectivity
  - Lectern
- Atrium

- Piano
  - Soft seating
  - Occasional tables
- Outdoor

- Electrical outlets for rear tent space
- Classrooms and Conference Rooms

- Chairs
  - 60" tables
- Game Room

- Chairs
  - 4-top card tables
- Art Studio

- Chairs
  - 60" tables
  - Sink
- Wellness Rooms

- Chairs and table as needed

Items listed are standard inventory; other options are available.

## Equipment

A/V Equipment is available upon request for any of the rental spaces. Options include SMART Boards with video conferencing capabilities, microphones, projectors, and screens. Please contact the rental manager for pricing and additional information.

Hearing Loops are available in the auditorium, all classrooms, and the large and small conference rooms.

Wifi is available throughout the building.

## A welcoming space with features and amenities to make your event a success.

- Universal design to ensure comfort and accessibility for all ages and abilities
- Abundant natural light
- Renewable energy from solar roof panels
- Convenient location accessible to public transportation
- Pedestrian-friendly parking lot
- **Greenberry's Coffee Co.** open during Center operating hours. Event catering also available.



# Floor Plan

## Level 1



## Site Plan



## Level 2

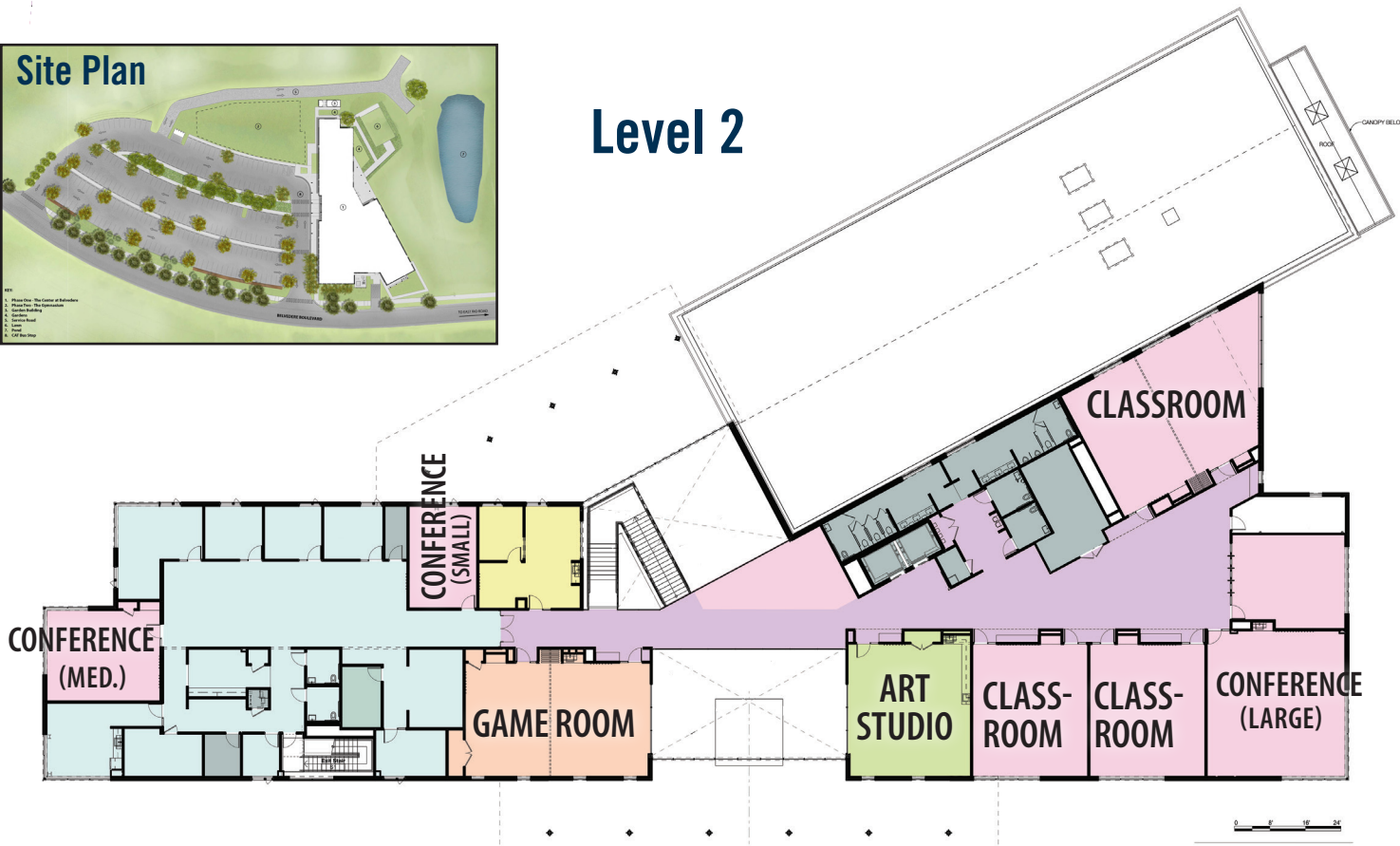

THE  
CENTER  
AT BELVEDERE

Rental Brochure

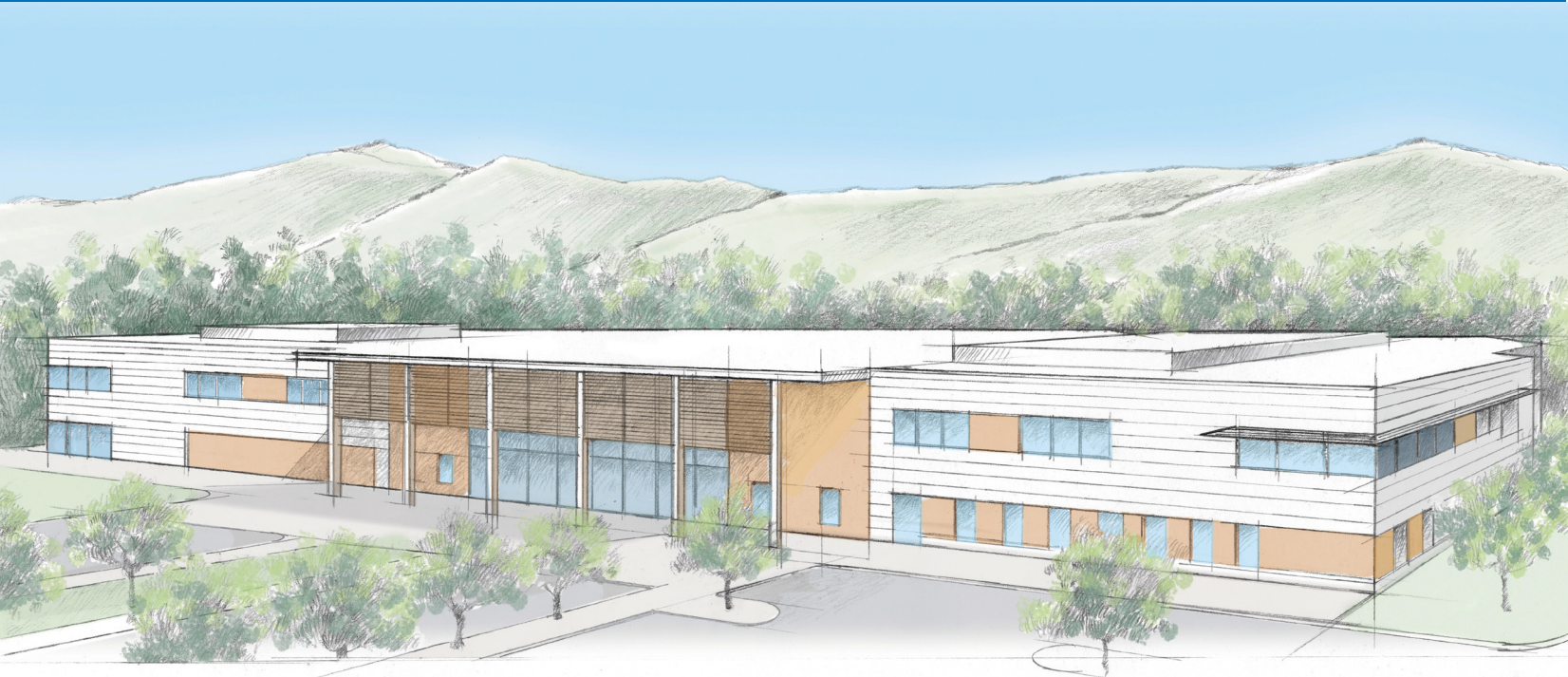



# PRIVATE EVENT RENTALS

## Event Spaces

*Note that photos are representational; construction will be completed in March 2020.*



Rendering courtesy of Bushman Dreyfus Architects



Photo by Ludwig Kwan from Pexels



Photo by Photos by Lanty on Unsplash

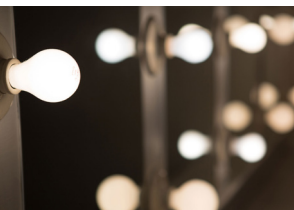

## AUDITORIUM

With sound clouds, a stage, large screen, and the option for natural light or blackout, the auditorium is a versatile space for hosting up to 380 people for performances or events. Your choice of banquet style or theater seating ensures a setup to suit your vision. Space includes backstage area and greenroom, plus easy access to catering kitchen. Auditorium can be divided to create a more intimate space. Rear auditorium rental does not include stage or backstage area.



Photo by Freixas on Unsplash

## CLASSROOMS

The Center offers three classrooms that let you choose the size that is most conducive to your group's learning experience. All rooms have adjacent lounge space and feature large windows with plenty of natural light. Large classroom can be divided for smaller gatherings.



## CONFERENCE ROOMS

Three conference rooms can be rented individually or in combination for meetings, lectures, breakout sessions, and more. Rooms are fully equipped for your conference needs, with furniture that offers a variety of setups and large windows for natural light.

## Event Spaces



## ATRIUM

With an abundance of natural light and a variety of seating areas, the atrium offers a dynamic hosting space. At 400 square feet, there is plenty of space for guests to gather and mingle. Rear doors open to a covered patio.



## THE CENTER GREEN

Outdoor space with room for a 40'x60' tent can accommodate receptions, parties, and presentations for up to 400 guests. A walkway leads from the lawn to a covered patio for additional space.

## THE CENTER FIELD

The side lawn is easily accessible and spacious enough for a 60'x100' tent, food trucks, or other setups.

## ART STUDIO

A versatile room with ample natural lighting and a work sink, the art studio is available for both art and craft classes. Tables can be configured to allow for project collaboration, life drawing, or any creative endeavor.

## GAME ROOM

With a glass wall that overlooks the atrium and 14 four-top tables perfect for a variety of games, this room is designed for fun. It can also be divided and reconfigured for alternate pursuits.

## WELLNESS ROOMS

These spaces allow privacy and comfort for a variety of personal services, from massage to consulting. Rooms are equipped with a table and chairs that can be removed or configured to accommodate your needs.

## Venue Capacity and Pricing

Room	Banquet Seating / Standing	Theater Style	Weekend Fri-Sun & Holidays	Weekday
Auditorium (incl. Atrium)	280 / 300 200 (with dance floor)	380	\$2400	\$1500
Front Auditorium (incl. stage, greenroom)	144 / 200	200	\$1800	\$1100
Rear Auditorium	96 / 140	140	\$1200	\$700
Atrium	n/a / 70	35	\$500	\$300
The Center Green The Center Field	200 / 300 400 / 400*	400 400*	\$900 \$900	\$500 \$500
Classrooms	Conference/Classroom Seating			
Large (up to 4 hours)	44	80	\$150	\$150
Medium (up to 4 hours)	24	60	\$125	\$125
Conference Rooms				
Large (up to 4 hours)	32	60	\$150	\$150
Medium (up to 4 hours)	18	36	\$125	\$125
Small (up to 4 hours)	12	25	\$125	\$125
Game Room (up to 4 hours)	52 seated (14 card tables)		\$150	\$150
Art Studio (up to 4 hours)	24		\$125	\$125
Wellness Rooms (up to 4 hours)	2-4		\$25	\$25

20% DISCOUNT FOR NONPROFIT AND PRIME MEMBERS

## Location and Parking

The Center is located in the beautiful Belvedere neighborhood, conveniently located just off E. Rio Road close to US 29 and the 250 Bypass, making it handy to downtown, UVA, and other local landmarks.

## Parking

The Center's lot has 230 spots. Street parking may also be available.

\* Available parking dictates event size.

## Public Transportation

CAT and JAUNT buses pull right up to the front door. For walkers and bikers, the neighborhood links up to the Rivanna Trail and the John Warner Parkway's 2.5 mile trail to downtown.

